



EAST WASHINGTON BOROUGH

Thayer Park Upgrades

July 26, 2021

Thayer Park History

Multi-Municipal Comprehensive Parks and Recreation Plan, Master Site Plans & Pool Study

- Public Meetings held Oct 5 & 5, 2011
 - Displayed master site plans
 - Identified areas of concern relating to facilities, programs, maintenance, etc.
 - Public Survey completed
- Mailed Public Surveys July 2011
- Final Public Meeting held October 4, 2012
- Final Plan – October 2013, enacted Resolution 2013 – 006, October 21, 2013.

Thayer Park History

Borough of East Washington Park

The Borough of East Washington Park is the Borough's only park. Located off Thayer Street, it is surrounded by a single-family residential neighborhood. At one-acre in size, the park is a neighborhood park. The park is an open area that features a pavilion and playground with a variety of play equipment and benches scattered throughout the site. There is no parking on-site, however, on-street parking is available on Thayer Street.



A complete inventory and analysis of the facilities within the park can be found in Appendix B-6.

Thayer Park History

Playground Equipment

- Purchased in Spring 2003
 - Pre-ADA requirements
 - Playground includes composite structure, 2 freestanding climbers, one spring rider, one merry-go-around, a “swing-gate” and a 2-bay, single axis swing set
- April 24 & 25, 2014, Safety Audit Performed and Recommendations Provided
 - Provide age-appropriate signage and caution about hot surfaces
 - No ADA Access to the site
 - Fall height and zone surfacing confinement not adequate, weeding and maintaining existing surface

Thayer Park Recent History

Council Planning 2015-Present

- Exercise Equipment for the Park
- ADA Parking Lot and accessibility to equipment
- Playground Equipment Improvement
 - ADA
 - Age Appropriate
 - Site Layout
- Applied for various funding opportunities including Washington County Local Share Account, DCED Greenways Trails and Recreation Grant, DCNR Park Rehabilitation and Development 2019-2020

Thayer Park Current Plans

Awarded Funding

- Borough approves use of \$40K CDBG funds a match
 - RACW approves use of \$40K for ADA accessible items
- Borough awarded DCED Greenways Trail and Recreation grant for \$75,000
- Borough contribute in-kind work through Public Works
 - Remove Existing Structures
 - Restore Existing site into greenspace

Thayer Park Current Plans

Awarded Funding

- Scope of Work:
 - ADA Access to the existing park
 - Off-Street Parking off of Hemlock Lane
 - New Playground Equipment
 - Including ADA Equipment/Access
 - Required Fall Spacing around equipment
 - Relocate Existing Equipment
 - Sewsaw
 - Infant Swings
 - Spinning Tulip

HEMLOCK AVENUE

Thayer Park Current Plans

INSTALL NEW PARKING LOT:

- 8" 2A STONE SUBBASE (283 SYD)
- 3.5" 19MM SUPERPAVE BITUMINOUS PAVEMENT (283 SYD)
- 1.5" 9.5MM SUPERPAVE BITUMINOUS PAVEMENT (283 SYD)
- LINE PAINTING
 - 9FT WIDE X 18FT LONG PARKING SPOT
 - 2 ADA SPOTS 9F WIDE X 18 FT SEPARATED BY A STRIPED OUT VAN ACCESS LOCATION
- 2 ADA SIGNS - ONE STANDARD, ONE VAN
- 2 CONCRETE CURB STOP LOCATED AT THE ADA SPOTS

INSTALL NEW PAVED WALKING PATH

- 45 FT LONG X 5 FT WIDE
- 6" 2A STONE SUBBASE (36 SYD)
- 3.5" 19 MM SUPERPAVE BITUMINOUS PAVEMENT
- 1.5" 9.5 MM SUPERPAVE BITUMINOUS PAVEMENT

RELOCATED SEWSAW

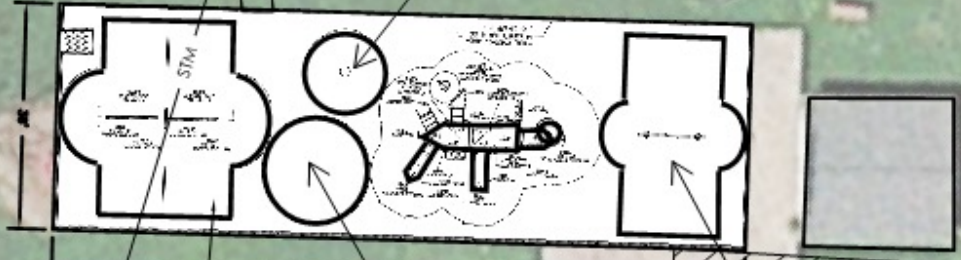

NEW PLAYGROUND

- RELOCATION OF EX. INFANT SWINGS
- INSTALLATION OF NEW PLAYGROUND STRUCTURE
- INSTALLATION OF NEW SWIRL WITH ME
- RELOCATION OF SPINNING CUP
- INSTALLATION OF NEW 2-BAY, SWINGSET

LOCATION OF FUTURE TOY

RELOCATED INFANT SWINGS

EX. PLAY GROUND PAD AREA TO BE REMOVED:

- TIMBERS TO SAVED FOR BOROUGH USE
- MULCH TO BE DISPOSED OF
- LOCATION TO BE TOPSOILED, SEEDED AND MULCHED

REMOVE SEWSAW - RELOCATE AS INDICATED ON THE SITE PLAN

REMOVE INFANT SWINGS - RELOCATE AS INDICATED ON THE SITE PLAN

REMOVE SPINNING TULIP - RELOCATE AS INDICATED ON THE SITE PLAN

INSTALL NEW COMPACTED STONE WALKING PATH

- 145 FT LONG X 5 FT WIDE
- 6" 2A STONE SUBBASE (81 SYD)
- 3.5" 19 MM SUPERPAVE BITUMINOUS PAVEMENT
- 1.5" 9.5 MM SUPERPAVE BITUMINOUS PAVEMENT

THAYER STREET

Thayer Park Playset Items



Hurricane Slide

Deck Height: 4'0" • 4'8" • 5'4" • 6'0"



Single Velocity Slide

Deck Height: 4'0" • 5'4" • 8'0"



Single Cascade Slide

Deck Height: 3'4" to 8'0"



Curvy Canopy Roof



Bench Seat

Available Below Decks



Drum Line

Available above and below decks



Triangle Transfer Point

With handhold & return step
Deck Height: 2' to 5'4"



Loop Arch Climber



8' Rock Climbing Wall

Deck Height: 8'0"

Thayer Park Playground General Items



3-1/2" O.D. Arch Swings

Model	Description	Beam Ht./Top Rail	ASTM Use Zone	
68034	Single Bay	8" (244 cm) high, 3-1/2" (9 cm) O.D.	32'0" x 24'10" 975 cm x 757 cm	\$1,367
68035	Add-A-Bay	8" (244 cm) high, 3-1/2" (9 cm) O.D.	32'0" x 12'5" 975 cm x 378 cm	\$ 843



PTAC Accessible Park Timber

Connects to Park Timbers to allow for easy access to the playground. Works with both 8" and 12" Park Timbers.

67743 | Black Price: \$404

67755 | Black with adapter Price: \$575

color options



Engineered Wood Fiber (EWF)

- Non-toxic and does not contain paint, chemicals, or additives
- Provides sufficient attenuation to meet minimal ASTM standards



Park Timber

67757 | 8" height

Price: \$58

66576 | 12" height

4' long, Black only

Price: \$57

A vibrant, cartoon-style illustration of a park. A winding path leads through a lush green landscape with several large, leafy trees. The sky is light blue with a few white clouds. The overall scene is bright and cheerful.

QUESTIONS?